

Lansdowne - 43 Centre Street

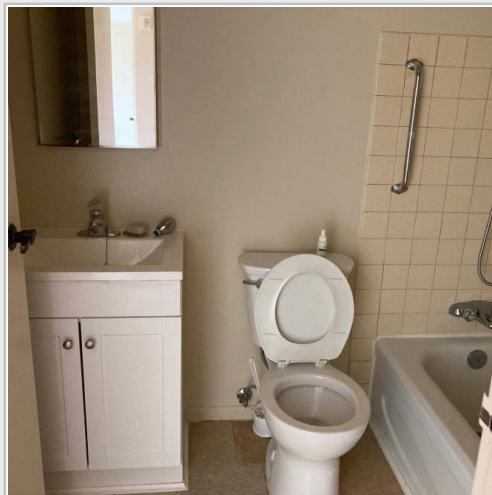

Year Built

1976

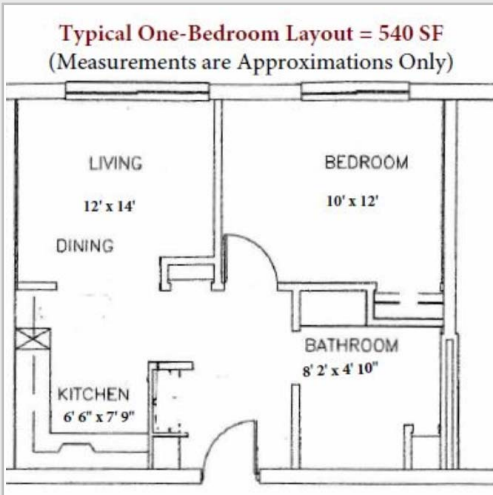

Unit Total

16 Units



Unit Sizes

16-1 Bedroom Units



Demographics

Seniors (Cascading Age 50+)

Other

Rent-Geared-to-Income
Smoke Free Units
2 Storey Building with Lift

Features

- After Hours Emergency Maintenance Line
- Custodian/Maintenance On-Site Regularly
- Common Room
- Fridge and Stove Included
- Groundskeeping and Snow Removal
- On-Site Coin Washer and Dryer
- Patio/Balcony
- Utilities Included
- Secure Building with Entry System
- Access to Shopping and Services
- Smoke Free Units
- 2 Storey Building with Lift

Not Included

- In-Unit Laundry/Dishwasher Not Permitted
- No Public Transit
- Parking Not Available, Waitlist for Space
- No Guest Parking



Social Housing Registry Contact Information

Telephone: 613-342-3840 ext. 2450
Toll Free: 1-800-267-8146 ext. 2450
Fax: 613-342-8908
Email: shr@uclg.on.ca

Website: <https://www.leedsgrenville.com/en/services/housing.aspx>